



4

3

2

1

DO NOT SCALE

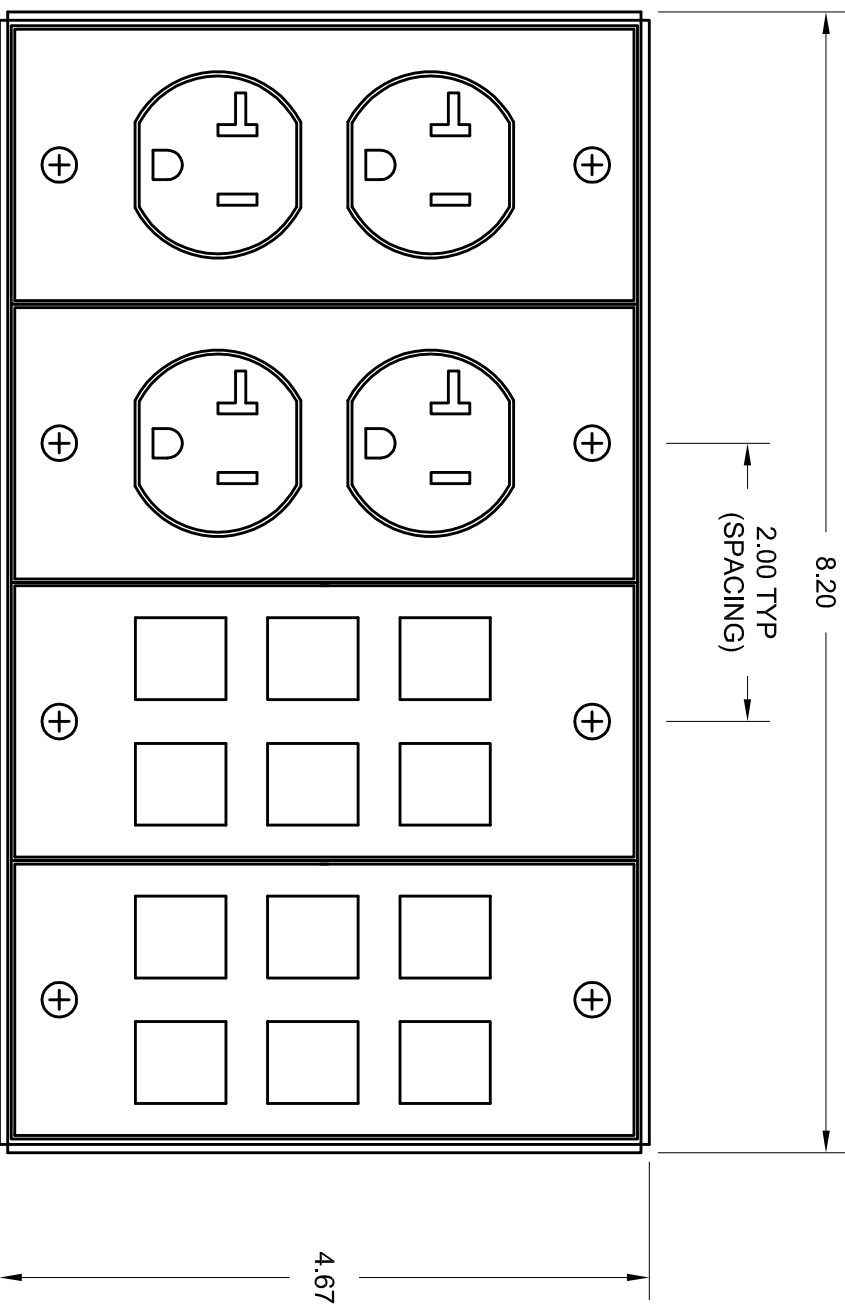

2.00 TYP
(SPACING)

8.20

4.67

1.81



B

B

A

A

4

3

2

1

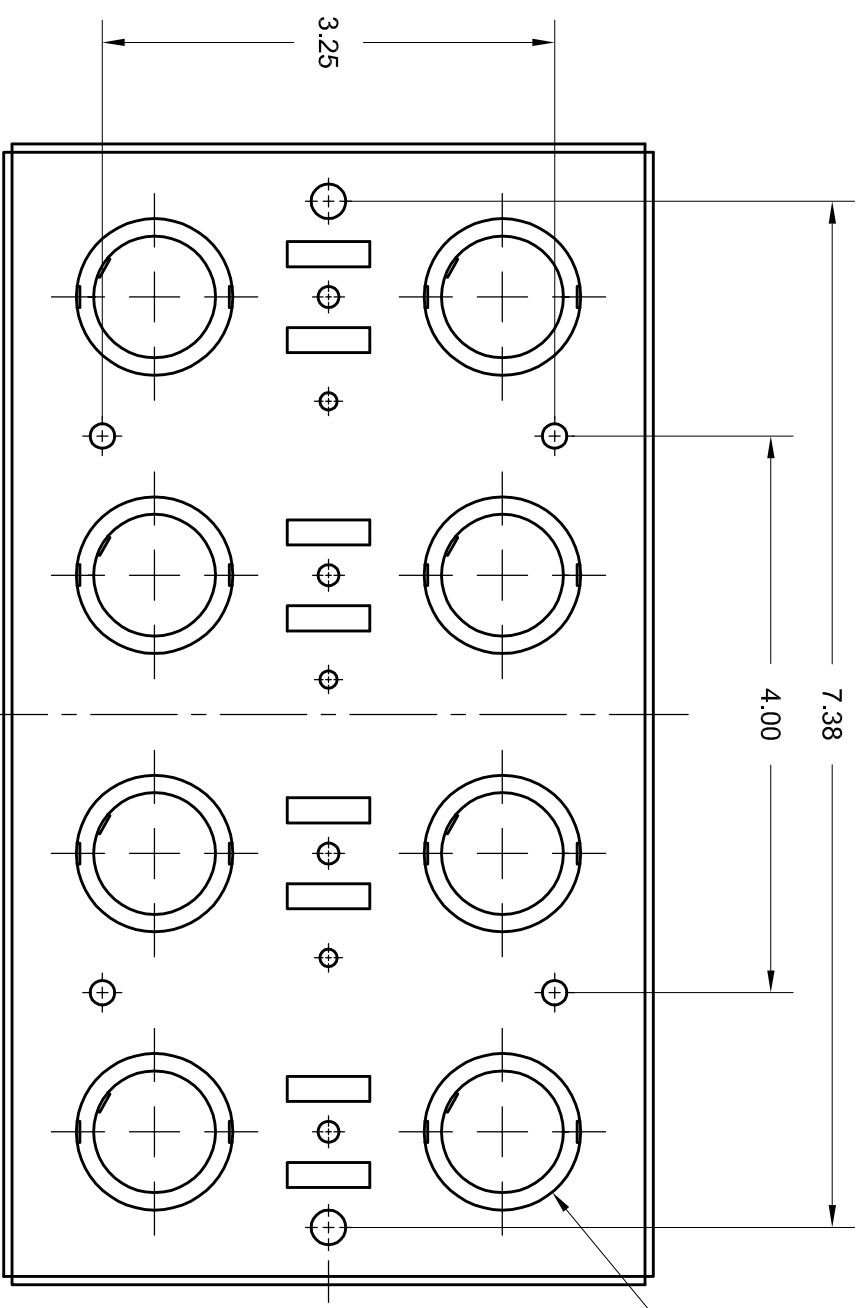

7.38

4.00

3.25

Ø1/2 X Ø3/4 DKO TYP
(Ø7/8 X Ø1 1/8 ACTUAL)

NOTES:
 THE FSCS4 IS POWDERCOATED WRINKLE BLACK (BY STANDARD); THERE ARE, HOWEVER, MULTIPLE COLOR, POWER, AND DATA OPTIONS. PLEASE CONTACT YOUR LOCAL SPIDER SALES REPRESENTATIVE FOR ALL AVAILABLE OPTIONS.



spider AGILE TECHNOLOGY

2821 Fernwick Road, Kelowna, BC V1X 5E4
P 250.765.2616 F 250.765.2614 www.spideragiletechnology.com

DESCRIPTION:

4 GANG SHALLOW SURFACE BOX

PROJECT:

FSCS4

SIZE:	B	DWG No.:	214	REV:	0
-------	---	----------	-----	------	---

SCALE:	NTS	RLS DATE:	2010.10.27	SHEET:	1 OF 1
--------	-----	-----------	------------	--------	--------

NOTES		PROCESS:	
ALL DIMENSION IN INCHES		MTRL:	16 GA CR STEEL SHEET
ALL DATES: YYYY.MM.DD		WT:	N/A
STANDARD TOLERANCES		DWG BY:	A.DZAKIC
X.X ± 0.050		CHK BY:	-
X.XX ± 0.010		ENG BY:	-
X.XXX ± 0.005		APR BY:	-
ALL ANGLES ± 0.5°		DATE:	2010.10.27
ALL STANDARDS ARE UNLESS OTHERWISE SPECIFIED		DATE:	-
		DATE:	-

CONFIDENTIAL

THIS DOCUMENT AND THE CONTENTS WITHIN ARE THE SOLE PROPERTY OF SPIDER MANUFACTURING INC. AND ARE NOT TO BE REPRODUCED, REDISTRIBUTED OR DISCLOSED WITHOUT WRITTEN CONSENT FROM SPIDER MANUFACTURING INC.

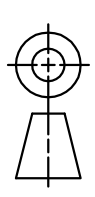

1

2

3

4

1

2

3

4

